

# NOTICE TECHNIQUE

## PARTS MANUAL

### TECHNISCHE TESCHREIBUNG

### TECHNISCHE GEGEVENS

**Rasenmäher**  
*Benzinmäher*

**MARQUE: FLORASELF**  
*Marke / Merk .*  
**MODELE: HB 5548BLR**  
*Type / Typ .*  
**REF.ARTICLE: 00025657**  
*Part Number / Typ Nr*

**MOTEUR: Briggs & Stratton**  
*Engine / Motor .*  
**MODELE : QUANTUM 55 CAT.**  
*Type / Typ .*

**LARGEUR DE COUPE : 48 cm**  
*Cutting width./ Schnittbreite / Maaibreedte*  
**CHASSIS: ALU**  
*Deck / Chassis .*  
**MODELE DE FABRICATION : 2000**  
*Year of Fabrication / Baujahr / Producttiejaar.*

ED : 13/01/00 96425657

( Avertissement : seuls les repères inscrits sur le tableau correspondent à votre machine )

Notice à conserver pour consultations ultérieures

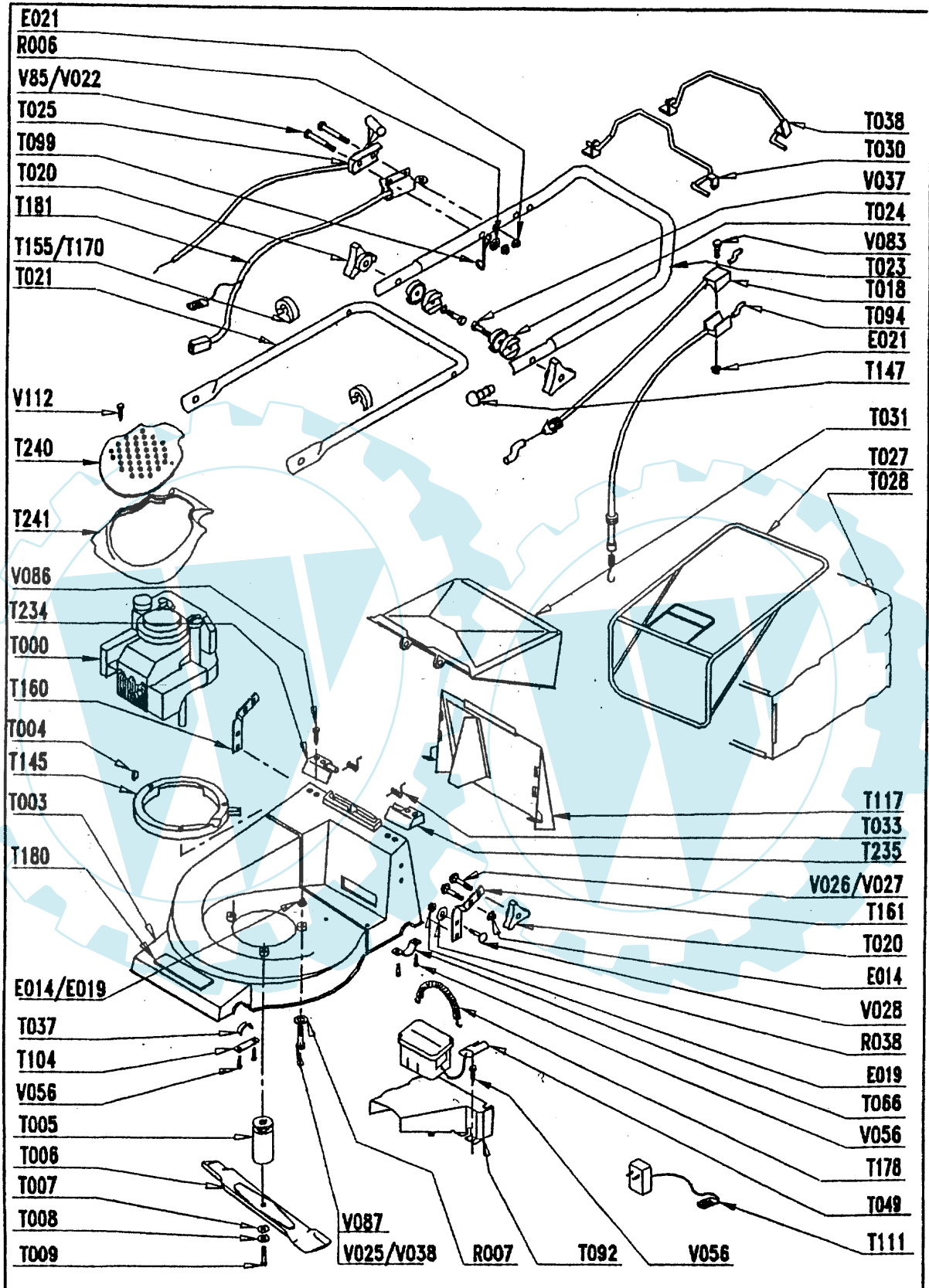

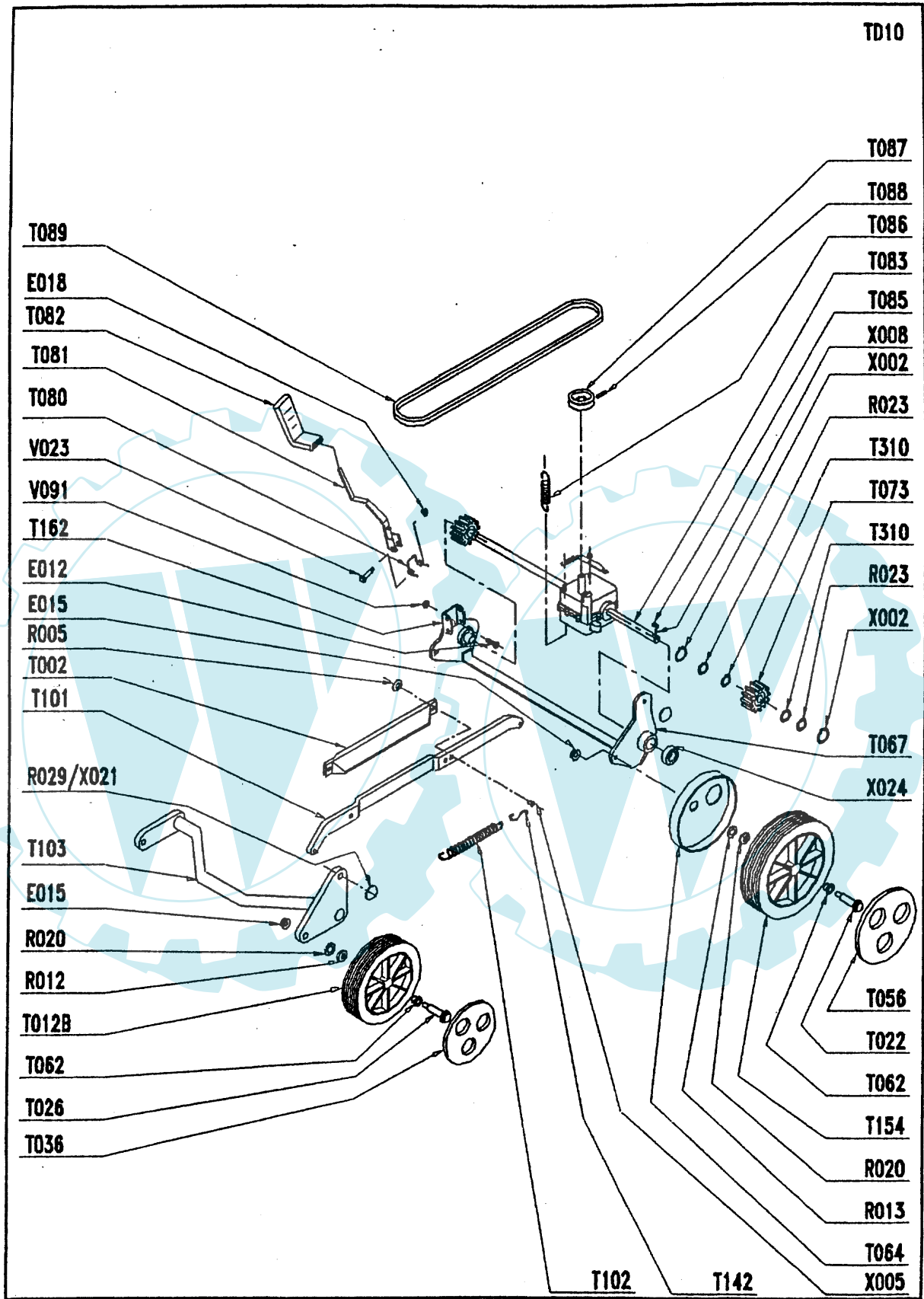

88

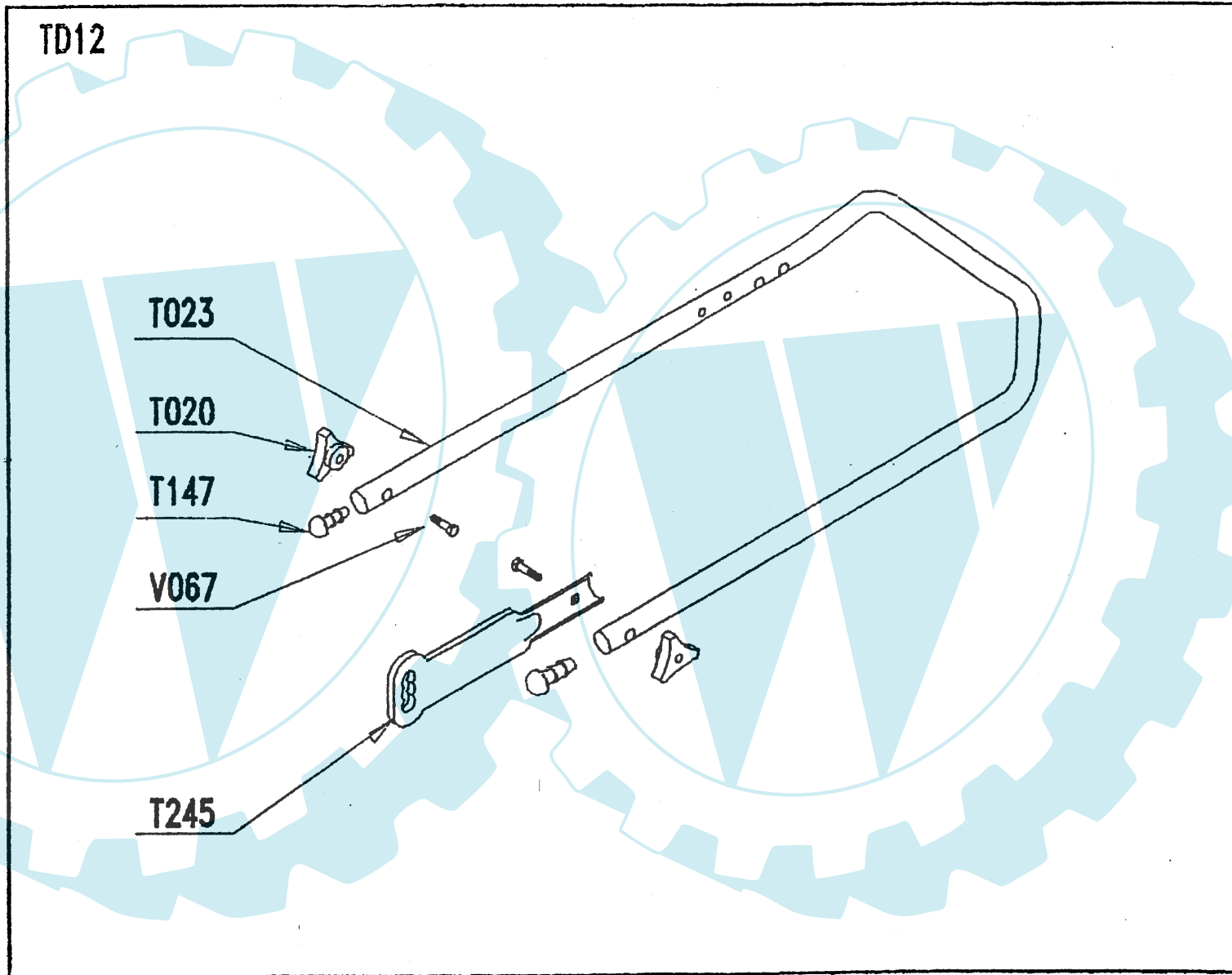

## REPERES CODE ARTICLE

|       |            |
|-------|------------|
| E012  | 90892078   |
| E013  | 90896083   |
| E014  | 90100044   |
| E015  | 90315001   |
| E019  | 90805504   |
| E021  | 90105406   |
| R005  | 90800035   |
| R006  | 90105058   |
| R007  | 90807501   |
| R012  | 90100067   |
| R013  | 90100068   |
| R020  | 90892018   |
| R023  | 97047308   |
| R029  | 90807507   |
| R038  | 062300     |
| T000  | 00100359   |
| T002  | M4961      |
| T003  | 050600/V   |
| T004  | 90892046   |
| T005  | 90808009   |
| T005  | 90808008   |
| T006  | 90892303   |
| T007  | 90803044   |
| T008  | 90803042   |
| T009  | 90892502   |
| T012B | 90892404   |
| T018  | 90892695   |
| T020  | 90892066   |
| T020A | 90892600   |
| T022  | 90892467   |
| T023  | 90892561   |
| T025  | 92100156   |
| T026  | 90892469   |
| T027  | 101202/0   |
| T028  | 101214/NF  |
| T030  | 90892507/N |
| T031  | 101100/1   |
| T033  | 101112/1   |
| T036  | 90892407   |
| T037  | 100215/0   |
| T038  | 90892534/N |
| T056  | M5938/J1   |
| T064  | M5565      |
| T066  | 060220/0   |
| T067  | 90808017/N |
| T073  | M5559      |
| T080  | 90803030   |
| T081  | 90808005/Z |
| T082  | 90803039   |
| T083  | 90808020   |

## REPERES CODE ARTICLE

|      |            |
|------|------------|
| T085 | 90803036   |
| T086 | 90803098   |
| T089 | 90805068   |
| T092 | 060632/0   |
| T094 | 90892349   |
| T099 | 100840/8   |
| T101 | 90808019/N |
| T102 | M4223      |
| T103 | 90808015/N |
| T104 | 100214/0   |
| T117 | 051208/N   |
| T142 | M1867      |
| T145 | 080626/N   |
| T147 | 90800013   |
| T154 | M5562      |
| T155 | M4780      |
| T160 | 90892559/N |
| T161 | 90892558/N |
| T234 | 100611/N   |
| T235 | 100613/N   |
| T240 | 90892651/N |
| T241 | 90892650/N |
| T245 | 90892538/N |
| T310 | 90896064   |
| V001 | 90803134   |
| V022 | 90105072   |
| V026 | 90105059   |
| V028 | 90105005   |
| V038 | 90105079   |
| V067 | 90800004   |
| V083 | 90105115   |
| V085 | 90105109   |
| V086 | 100620/0   |
| V087 | 90105093   |
| V091 | 90805112   |
| V112 | 90805502   |
| X002 | 90892026   |
| X005 | 90105096   |
| X008 | 90803035   |
| X024 | 97047309   |